

West Area Planning Committee Presentation

18/01340/FUL

Trinity College – Site photos

57

www.oxford.gov.uk



Location Plan

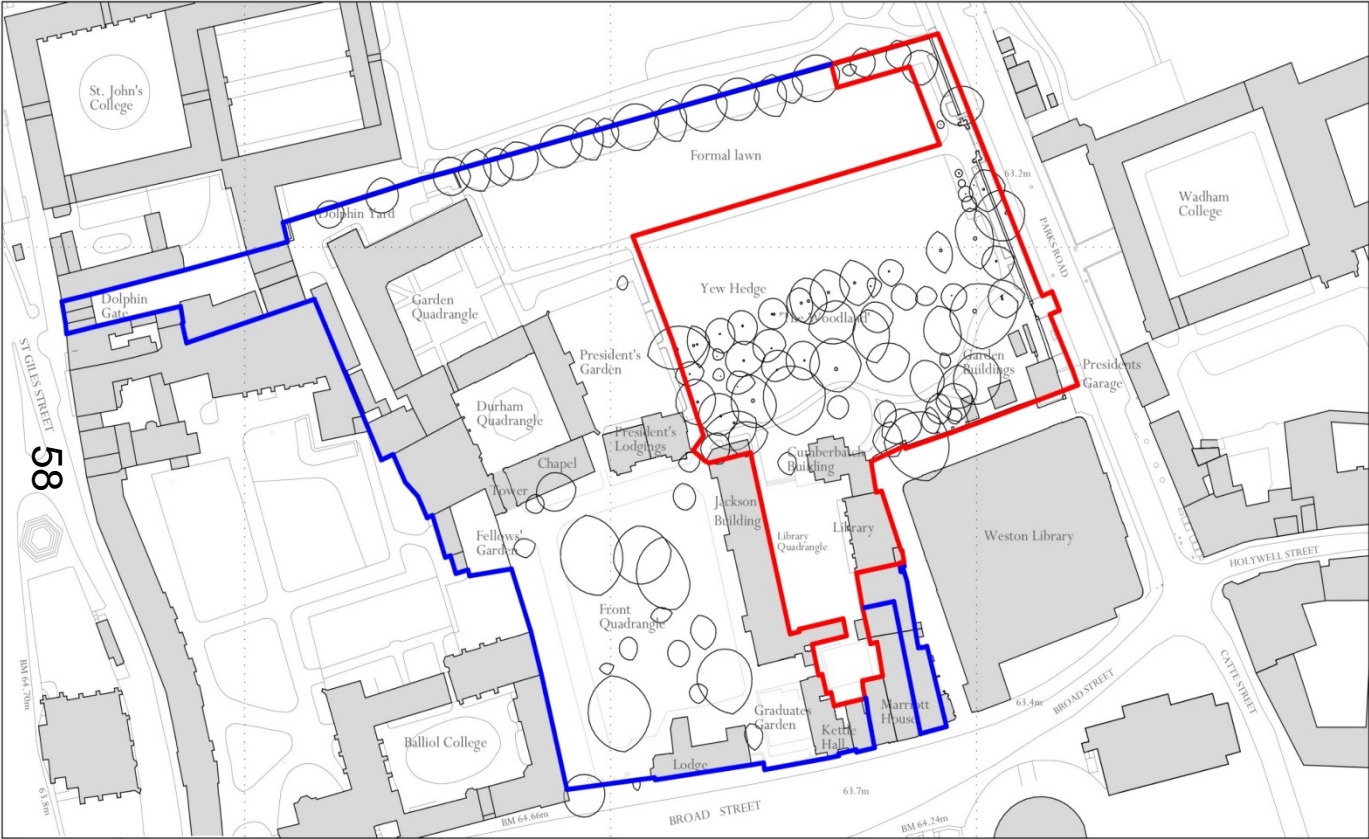

Survey (c) Crown Copyright 2018. All rights reserved. Licence number 100022432

Adjacent Properties and Boundaries are shown for illustrative purposes only and have not been surveyed unless otherwise stated.
All areas shown are approximate and should be verified before forming the basis of a decision.
Do not scale other than for Planning Application purposes.
All dimensions must be checked by the contractor before commencing work on site.
No deviation from this drawing will be permitted without the prior written consent of the Architect.
The copyright of this drawing remains with the Architect and may not be reproduced in any form without prior written consent.
Ground Floor Slabs, Foundations, Sub-Structures, etc. All work below ground level is shown provisionally. Inspection of ground condition is essential prior to work commencing.
Reassessment is essential when the ground conditions are apparent, and redesign may be necessary in the light of soil conditions found. The responsibility for establishing the soil and sub-soil conditions rests with the contractor.



Scale 1:1250

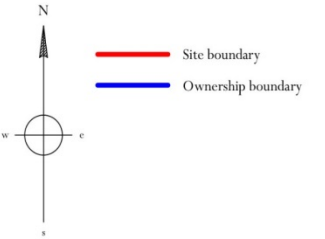

| Rev | Date | Description | Initials |
|-------------|------------|---|----------|
| PROJECT | | Trinity College | |
| | | New Teaching, Residential & Auditorium Building | |
| TITLE: | | Site Location Plan | |
| SCALE: | 1:1250 @A3 | | |
| DATE: | 2018/04 | | |
| DRAWING No: | 5446/01 | | |
| DRAWN BY: | AMS | | |

ADAM ARCHITECTURE
OLD HYDE HOUSE, 75 HYDE STREET
WINCHESTER, HAMPSHIRE, SO3 7DW
TELEPHONE: 01962 843843 FACSIMILE: 01962 843303
www.adamarchitecture.com contact@adamarchitecture.com

LONDON OFFICE: 6 QUEEN SQUARE, WC1N 3AT
TELEPHONE: 020 7841 9140 FACSIMILE: 01962 843303
ADAM ARCHITECTURE IS A TRADING NAME OF ADAM ARCHITECTURE LIMITED

Ariel View of Trinity College and the site

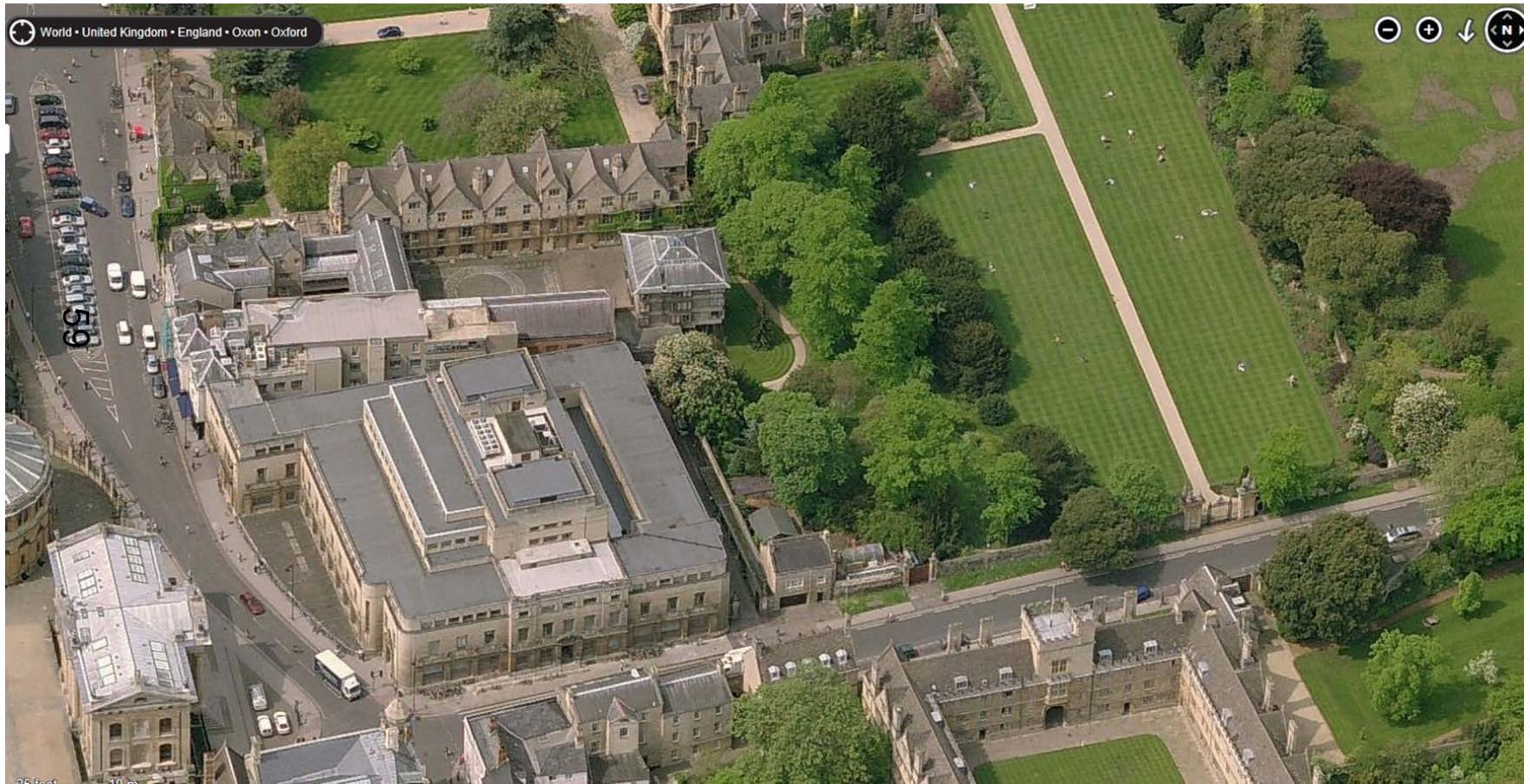

Courtesy of GoogleMaps

View from Parks Road towards Weston Library



View of site from Parks Road





62

Wadham College and Kings Arms PH opposite the site on Parks Road



View into Trinity College's formal lawn through the Stuart Gates on Parks Road



View into Trinity College's formal lawn to Garden Quad (listed grade I)



Oblique view of Cumberbatch
through the gates



The President's Garage, Parks Road

67



The President's Garage & side access of Weston Library, Parks Road

89



North elevation of the Weston Library



View to site down side access
of the Weston Library, Broad St

70



View towards the Cumberbatch Building across the formal lawn, yews trees to the forefront



View towards the Cumberbatch from across the formal lawn (adjacent to Parks Road)



View towards the Cumberbatch and Weston from across the formal lawn (half way down)



View of the
Cumberbatch Building
within Trinity's
'Wilderness' Garden

74



Library Quad, Library LHS , Norrington Room below ground



View of the rear of the Cumberbatch Building, Library Quad



The Library and
Cumberbatch Building,
Library Quad

77



Jackson Building, Library Quad



Inside the Weston Library Conservation workshop

79



Inside the Weston Library Conservation workshop



View out through the Weston Library Conservation workshop windows



View from one of the Conservation workshop windows towards the site



View from Weston Library Reading Room windows towards the site



Inside the Reading Room, Weston Library

84



Inside the Reading Room, Weston Library

85



Inside the Reading Room,
Weston Library

88



View out of one of the Reading
Room windows towards the site,
Weston Library

87



View of one of the Reading
Room windows,
Weston Library

88



Closer view out of one of the
Reading Room Windows

89



View from Weston Library Reading Room window towards the site and Parks Road



View from Weston Library (stair case) towards the site (President's Garage)



View from Weston Library (stair case) towards the site



View out towards the site
across the Weston Library's
side access and the gardeners
buildings behind the President's
Garage.

63



This page is intentionally left blank